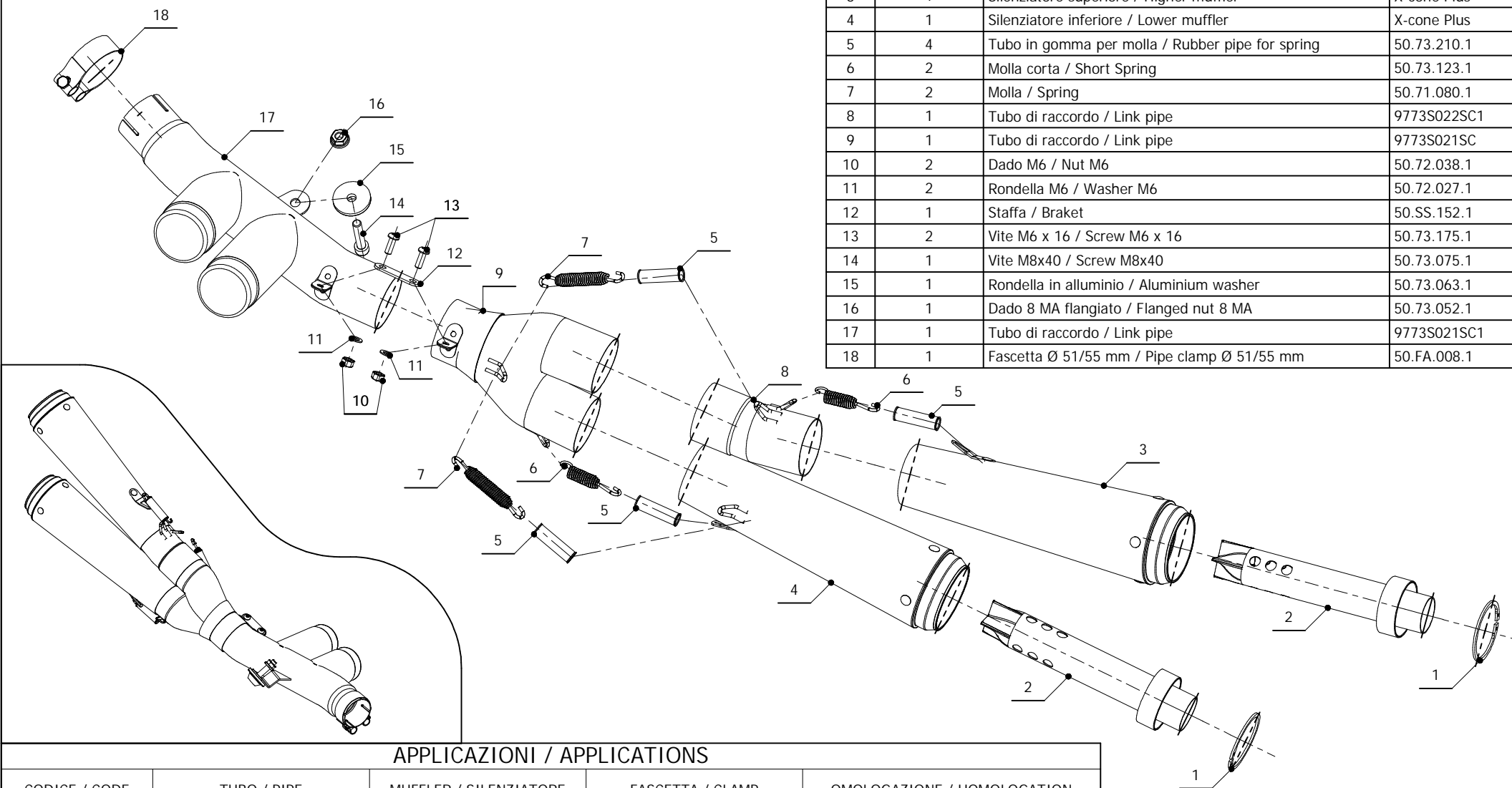

ELENCO PARTI / PARTS LIST

#	QTÀ / QTY	DESCRIZIONE / DESCRIPTION	CODICE / CODE
1	2	Anello Seger / Seger ring	50.73.218.1
2	2	DB killer / DB killer	50.DK.033.0
3	1	Silenziatore superiore / Higher muffler	X-cone Plus
4	1	Silenziatore inferiore / Lower muffler	X-cone Plus
5	4	Tubo in gomma per molla / Rubber pipe for spring	50.73.210.1
6	2	Molla corta / Short Spring	50.73.123.1
7	2	Molla / Spring	50.71.080.1
8	1	Tubo di raccordo / Link pipe	9773S022SC1
9	1	Tubo di raccordo / Link pipe	9773S021SC
10	2	Dado M6 / Nut M6	50.72.038.1
11	2	Rondella M6 / Washer M6	50.72.027.1
12	1	Staffa / Braket	50.SS.152.1
13	2	Vite M6 x 16 / Screw M6 x 16	50.73.175.1
14	1	Vite M8x40 / Screw M8x40	50.73.075.1
15	1	Rondella in alluminio / Aluminium washer	50.73.063.1
16	1	Dado 8 MA flangiato / Flanged nut 8 MA	50.73.052.1
17	1	Tubo di raccordo / Link pipe	9773S021SC1
18	1	Fascetta Ø 51/55 mm / Pipe clamp Ø 51/55 mm	50.FA.008.1

APPLICAZIONI / APPLICATIONS

CODICE / CODE	TUBO / PIPE	MUFFLER / SILENZIATORE	FASCETTA / CLAMP	OMOLOGAZIONE / HOMOLOGATION
S.022.LP1	INOX / STAINLESS STEEL	INOX / STAINLESS STEEL	INOX / STAINLESS STEEL	OMOLOGATO / HOMOLOGATED